

Trim the end of a pipe/Cut a pipe in half

This function allows you to easily send a single straight or miter cut to the machine to make one cut (not cutting a two ended part).

This functionality only appears when you are at the PypeServer system connected directly to the machine.

Select the “Cut Off Pipe” button in the upper right hand corner of the application.

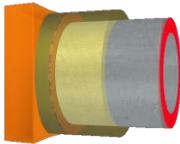

Clicking this button will create a part with a single Miter cut of the size of the currently loaded (or last loaded) part or pipe.

- You can modify the cut-off cut with the regular cut parameters (including bevel angle, feed rate, etc.)
- You load the single cut Part to the machine.
- Once loaded the system immediately offers to delete the cut from the database.

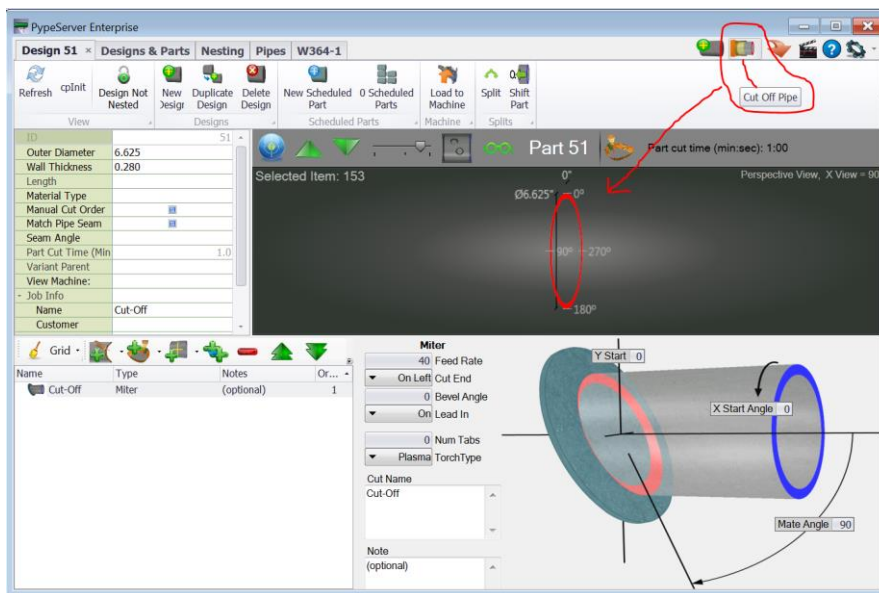

Once loaded, be sure to position the torch where you want the cut to be; the cut will begin where the torch is positioned.